

Pioneer

SPH-10BT

Pioneer Smart Sync Smartphone¹ Receiver Featuring Built-In Cradle for Smartphone, Enhanced Multimedia Functions, USB Port and Built-in Bluetooth[®]



- Works with Pioneer Smart Sync App
- Made for iPhone[®] Connectivity
- Compatible with Android[™] Smartphones
- Bluetooth[®] Connectivity
- Smartphone App Control
 - (Music, Navigation, Messaging)
- Direct Access Key - Navigation
 - (Waze[™], Google Maps[™], Apple[®] Maps)
- Integrated Smartphone Cradle²



Pioneer's SPH-10BT, the perfect match for today's on-the-go lifestyle, offers a new approach to smartphone connectivity. Simply mount your smartphone¹ in the built-in cradle², then connect (either wirelessly or wired,) to the Pioneer Smart Sync app³ and enjoy a smarter connected driving experience. Specially designed for easy use, the SPH-10BT features direct access buttons that work with the Pioneer Smart Sync app to bring multimedia capabilities such as navigation, hands-free calling, messaging, and voice-command to a single-DIN receiver.

FEATURES



Pioneer Smart Sync

Pioneer Smart Sync is a highly evolved technology that links your smartphone to Pioneer car audio and entertainment systems. By utilizing more of your smartphone's features, it expands, evolves and furthers the enjoyment of every moment you spend in your car. With the Pioneer Smart Sync app, you can bring your smartphone's maps, messages, and music together in the car. To learn more about the Pioneer Smart Sync app, visit www.pioneer-carglobal.com/pss.



Download the Pioneer Smart Sync app from the App Store[®] and Google Play[®].

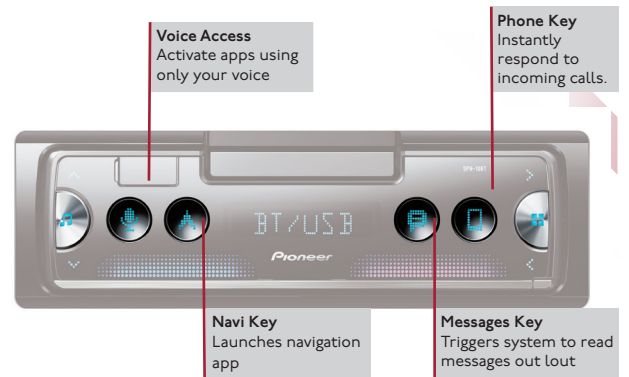

Back-Up Sensors

Get obstacle detection on your smartphone display when used in conjunction with the ND-PSI Rear Parking Sensors (sold separately, requires professional installation) and the Pioneer Smart Sync app.



Pioneer CD-Receivers		MVH-S310BT	SPH-10BT
Display	Display with LED Backlight	VA LCD (2-Line)	VA LCD (2-Line)
	Color customization	No	No
Bluetooth	Built-in Bluetooth for calling	HFP 1.6	HFP 1.6
	Built-in Bluetooth for audio streaming and device control	AVRCP 1.5, A2DP, SPP,	AVRCP 1.5, A2DP, SPP
	Other Bluetooth features	Secure Simple Pairing (SSP), dual phone simultaneous pairing	Secure Simple Pairing (SSP), dual phone simultaneous pairing
Tuner & Sources	Supertuner® IID	Yes	Yes
	RDS (Radio Data System)	Yes	No
	USB input	Yes, front (1.5 amp charging capable)	Yes, front (1.5 amp charging capable)
	Aux Input	Yes	No
Smartphone Expandability	Android™ music support	Media Transfer Protocol (MTP)	Media Transfer Protocol (MTP)
	USB direct control for iPhone®	Yes (iPhone only)	Yes (iPhone only)
	Pandora® Radio ready	Android™ via Bluetooth®/ iPhone® via Bluetooth® and USB	Yes, Configuration Required
	Spotify® app control	Android™ via Bluetooth®/ iPhone® via Bluetooth® and USB	Yes, Configuration Required
Pioneer Smart Sync Expandability	Pioneer App Compatibility	Pioneer Smart Sync	Pioneer Smart Sync
	Direct Access Keys for Voice, NAVI, and Messages	No	Yes
	Smartphone Cradle	No	Yes
	Parking Sensor (ND-PS1) Compatible	No	Yes
	Voice Recognition	No	Yes
Digital Media Playback	FLAC (Free lossless Audio Codec) support	Playback of files up to 96kHz/24 bit resolution (USB input only)	Playback of files up to 96kHz/24 bit resolution (USB input only)
	Digital audio media playback (non-DRM content only)	MP3, WMA, AAC, WAV	MP3, WMA, AAC, WAV
Audio	RCA preouts	2 - 2V	2 pair, 2V
	Built-in amplifier	Yes	Yes
	Customizable Equalizer	13 Band EQ 31 Band with Pioneer Smart Sync	13 Band EQ + 31 Band with Pioneer Smart Sync
	Built-in crossover network	HPF front/rear; LPF subwoofer	Yes, with Pioneer Smart Sync App
	Subwoofer Control	Yes	Yes, with Pioneer Smart Sync App
	Listening Position Selector	Yes	Yes, with Pioneer Smart Sync App
	Advanced Sound Retriever	Yes	Yes, with Pioneer Smart Sync App
	Super Todoroki Sound	No	Yes, with Pioneer Smart Sync App
General	Enhanced Environmental Protection Design	Yes	No
	Detachable Face Security	Yes	Yes
	Wireless remote control	Optional	Optional
	Multi-language UI	English, French, Spanish	English, French, Spanish

..... For full specifications and other Pioneer products, visit www.pioneerelectronics.com

CAUTION: Read the operation manual as well as all instructions and cautions before use. Pay attention to the road, limit glances to the device, and do not use any feature if it cannot be operated both safely and legally in your location and environment. Distracted driving may result in serious injury, including death.

¹Smartphone sold separately.
²Do not use the built-in cradle if your smartphone would cover, obscure or block indicators (lamps) relating to vehicle system status and operation, such as Passenger Air Bag, Air Bag Malfunction, Anti-Lock Braking System and Electronic Stability Control (ESC). Use an appropriate alternate mounting device to secure the smartphone in a location that does not block indicators, controls or vents, violate the law, or cause a hazard.
³The SPH-10BT is designed to be used only with the Pioneer Smart Sync app on a smartphone mounted securely, safely, and legally within your vehicle. Any other use of the smartphone while driving may be dangerous and violate the law.

Video playback is enabled only when the vehicle is in park and the parking brake engaged.

Bluetooth functionality requires a compatible Bluetooth-enabled mobile phone. Certain Bluetooth features may not be supported by all compatible Bluetooth-enabled devices, and/or the functionality of such features may be limited in certain devices or by certain wireless carriers.
 Not every USB device is compatible with a Pioneer headunit containing a USB port. For size and other limitations, please see Owner's Manual. Unauthorized copying of music or other files is strictly prohibited.

Pandora internet radio is a music service not affiliated with Pioneer. More information is available at www.pandora.com. Requirements to access the Pandora music service using a Pioneer system: iPhone using iOS-9 or later; compatible with Android OS 4.1.1 or higher; Pandora application; current Pandora account; wireless data plan; and iPhone cable for iPhone device. Android devices require a Bluetooth connection that support both SPP (Serial Port Profile) and A2DP (Advanced Audio Distribution Profile). Pandora service is currently only available in the U.S.

Spotify is a music service not affiliated with Pioneer. More information is available at www.spotify.com. Requirements to access the Spotify music service using a Pioneer system: iPhone 5c or newer with OS 8.0 or later; compatible Android smartphone; Spotify application; current Spotify account; wireless data plan; and iPhone cable may be required for iPhone depending on model. Android devices require a Bluetooth connection that support both SPP (Serial Port Profile) and A2DP (Advanced Audio Distribution Profile). Spotify service is currently only available in the U.S., Australia, Mexico, Singapore, China, and parts of Western Europe.
 Connected services require connection to a wireless

network via a compatible iPhone or Android smartphone device. Ability to use such services will depend on network availability. If your data plan does not have unlimited data, charges from your carrier may apply. Availability of non-Pioneer content and services, including apps and connectivity, may change without notice due to changes in operating systems, firmware or app versions; changes to, restrictions on or discontinuation of the service or service plans; non-Pioneer hardware changes; or other events.

PIONEER and the Pioneer logo are trademarks or registered trademarks of Pioneer Corporation.

Android, Android Auto, Android Auto Wireless and Google Play are trademarks of Google LLC. Apple iPod, and the iPhone logo are trademarks of Apple Inc., registered in the US and other countries. Bluetooth® and associated logos are trademarks of Bluetooth SIG, Inc. Pandora, the Pandora logo, and the Pandora trade dress are trademarks or registered trademarks of Pandora Media, Inc. used with permission. Spotify, the Spotify logo, and the Spotify trade dress are trademarks or registered trademarks of Spotify AB used with permission. All other brand, product names, or logos are trademarks or registered trademarks of their respective holders.

Pioneer Electronics (USA) Inc. proudly supports and encourages you to support the Consumer Technology Association (CTA), Mobile Electronics Certification Program (MECP) for installers and the Specialty Equipment Market Association (SEMA).



Protect your investment. Purchase from an Authorized Pioneer Dealer. Only products purchased from an Authorized Pioneer Dealer (or Authorized Pioneer Internet Dealer) qualify for the manufacturer's warranty and manufacturer's rebates.

Pioneer Electronics (USA) Inc., Post Office Box 1760, Long Beach, California 90801

Pioneer Customer Service Department: 1-800-PIONEER

Note: Specifications, designs, and user interfaces are subject to modification without notice. Product colors and illumination may differ in photographs from actual appearance due to effects of printing and photography.

CHECK OUT MORE AT
PIONEERELECTRONICS.COM/CAR

- FACEBOOK.COM/PIONEERNORTHAMERICA
- INSTAGRAM.COM/PIONEERCARAUDIO
- TWITTER.COM/PIONEERUSA
- YOUTUBE.COM/PIONEERELECTRONICS